

# TIG Welding Torch SR 24 W liquid cooled



BINZEL. The right welding torch for every job!

BINZEL liquid cooled welding torches have the high quality and technology needed for trouble-free performance whatever the welding job.

All BINZEL torches are constructed to the highest standards and offer the greatest working comfort.

This brochure defines in detail all the possible options for the above TIG torch types.

#### Technical Data:

SR 24 W  
Rating: 140 A DC  
125 A AC  
Tungsten electrode:  $\varnothing$  0,5 - 2,4 mm

As each torch type has very many variations, we cannot list them all here. Therefore, we indicate only one standard for each type of torch.

Type	Handle version	4,00 m long	8,00 m long
		Part no.	Part no.
SR 24 W	with single connection, single action switch and 3-pole Tichel connector	705.0461*	705.0462*

\* This part number is a sample, only, which refers to the mentioned „Standard version“. To other torch variations new order numbers will be given. See order confirmation.

Welding & cutting brought to the point.



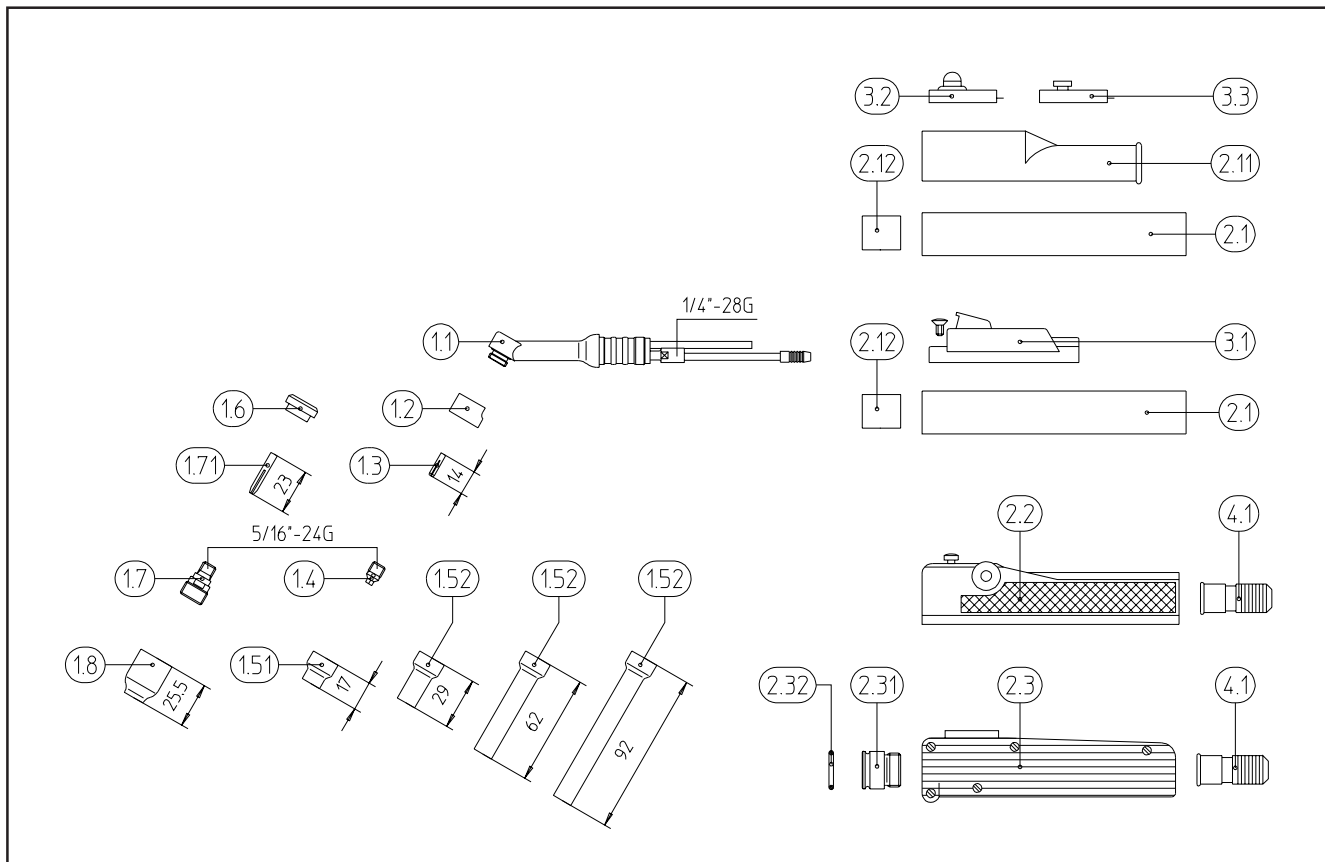

Build group	Pos.	Description	Specifications	Part no.
<b>Torch body</b>	1.1	Torch body SR 24 W		705.0080
<b>Wear parts</b>	1.2	Insulator gasket		701.0458
	1.3	Collet 14.0 mm long for electrode- Ø 0.5 mm Collet 14.0 mm long for electrode- Ø 1.0 mm Collet 14.0 mm long for electrode- Ø 1.2 mm Collet 14.0 mm long for electrode- Ø 1.6 mm Collet 14.0 mm long for electrode- Ø 2.0 mm Collet 14.0 mm long for electrode- Ø 2.4 mm		701.0452 701.0453 701.0455 701.0454 701.0456 701.0457
	1.4	Collet body for electrode- Ø 0.5 mm Collet body for electrode- Ø 1.0 mm Collet body for electrode- Ø 1.2 mm Collet body for electrode- Ø 1.6 mm Collet body for electrode- Ø 2.0 mm Collet body for electrode- Ø 2.4 mm		701.0479 701.0480 701.0483 701.0481 701.0484 701.0482
	1.51	Alumina cup, no. 4, Ø 6.5 mm, 17.0 mm long Alumina cup, no. 5, Ø 8.0 mm, 17.0 mm long Alumina cup, no. 6, Ø 9.5 mm, 17.0 mm long		701.0468 701.0469 701.0470
	1.52	Alumina cup, no. 4L, Ø 6.5 mm, 29.0 mm long Alumina cup, no. 6L, Ø 9.5 mm, 29.0 mm long Alumina cup, no. 4L, Ø 6.5 mm, 62.0 mm long Alumina cup, no. 5L, Ø 8.0 mm, 92.0 mm long		701.0471 701.0472 701.0473 701.0474

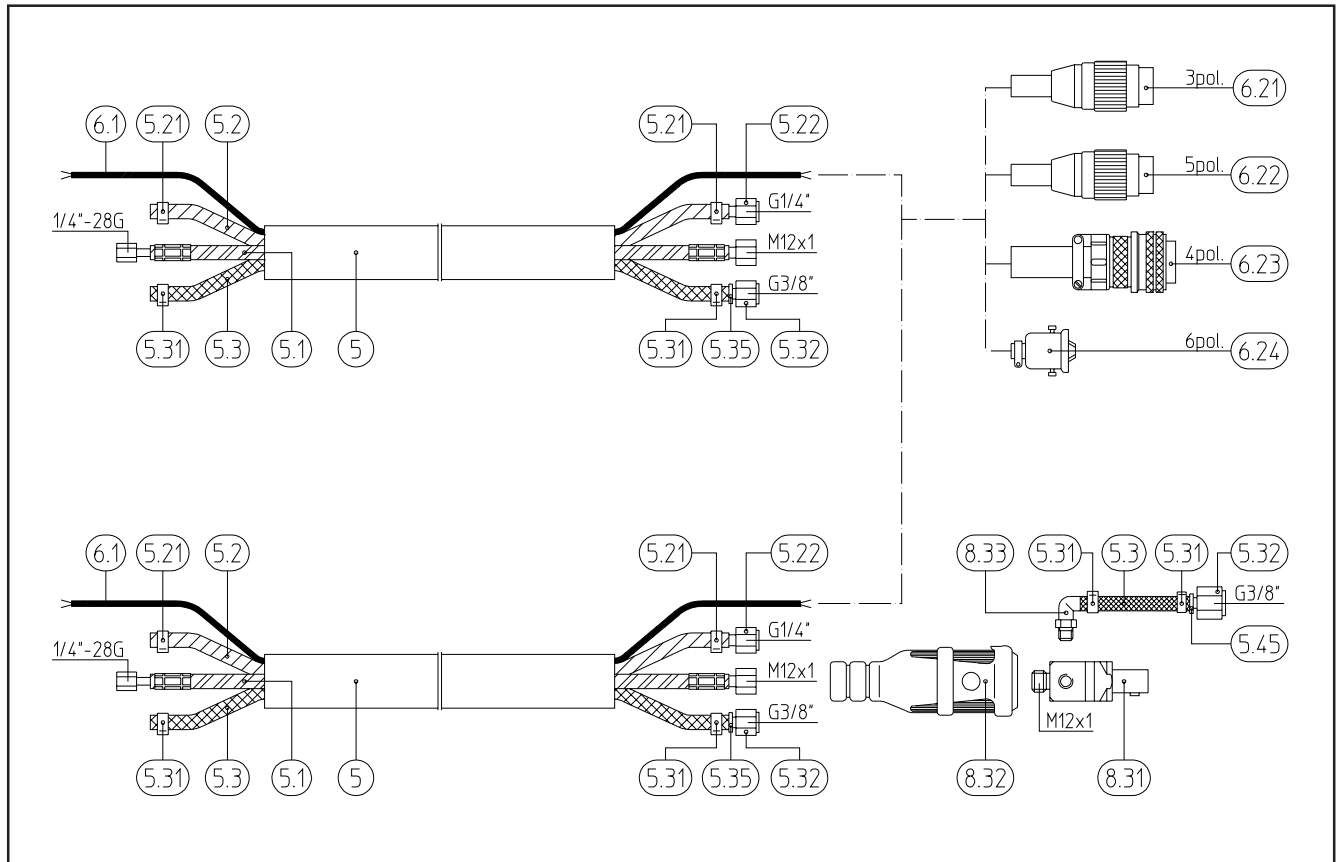

Build group	Pos.	Description	Specifications	Part no.
<b>Wear parts</b>		Gas lens accessories		
	1.6	Insulator		701.0459
	1.7	Collet body with gas lens for electrode- Ø 0.5-1.0 mm		701.0301
		Collet body with gas lens for electrode- Ø 1.2 mm		701.0313
		Collet body with gas lens for electrode- Ø 1.6 mm		701.0307
		Collet body with gas lens for electrode- Ø 2.0 mm		701.0315
		Collet body with gas lens for electrode- Ø 2.4 mm		701.0309
	1.71	Collet 23.0 mm long for electrode- Ø 0.5 mm		701.0461
		Collet 23.0 mm long for electrode- Ø 1.0 mm		701.0462
		Collet 23.0 mm long for electrode- Ø 1.2 mm		701.0464
	Collet 23.0 mm long for electrode- Ø 1.6 mm		701.0463	
	Collet 23.0 mm long for electrode- Ø 2.0 mm		701.0466	
	Collet 23.0 mm long for electrode- Ø 2.4 mm		701.0465	
1.8	Alumina cup, no. 4, Ø 6.5 mm, 25.5 mm long		701.0317	
	Alumina cup, no. 5, Ø 8.0 mm, 25.5 mm long		701.0318	
	Alumina cup, no. 6, Ø 9.5 mm, 25.5 mm long		701.0319	
	Alumina cup, no. 7, Ø 11.0 mm, 25.5 mm long		701.0320	
<b>Handle and switch</b>	2.1	Handle tube		701.0329
	2.12	Insert bush		705.0338
	2.11	Rubber boot		701.0105
	2.2	Handle with single action switch		705.0023
		Handle with double action switch		705.0024

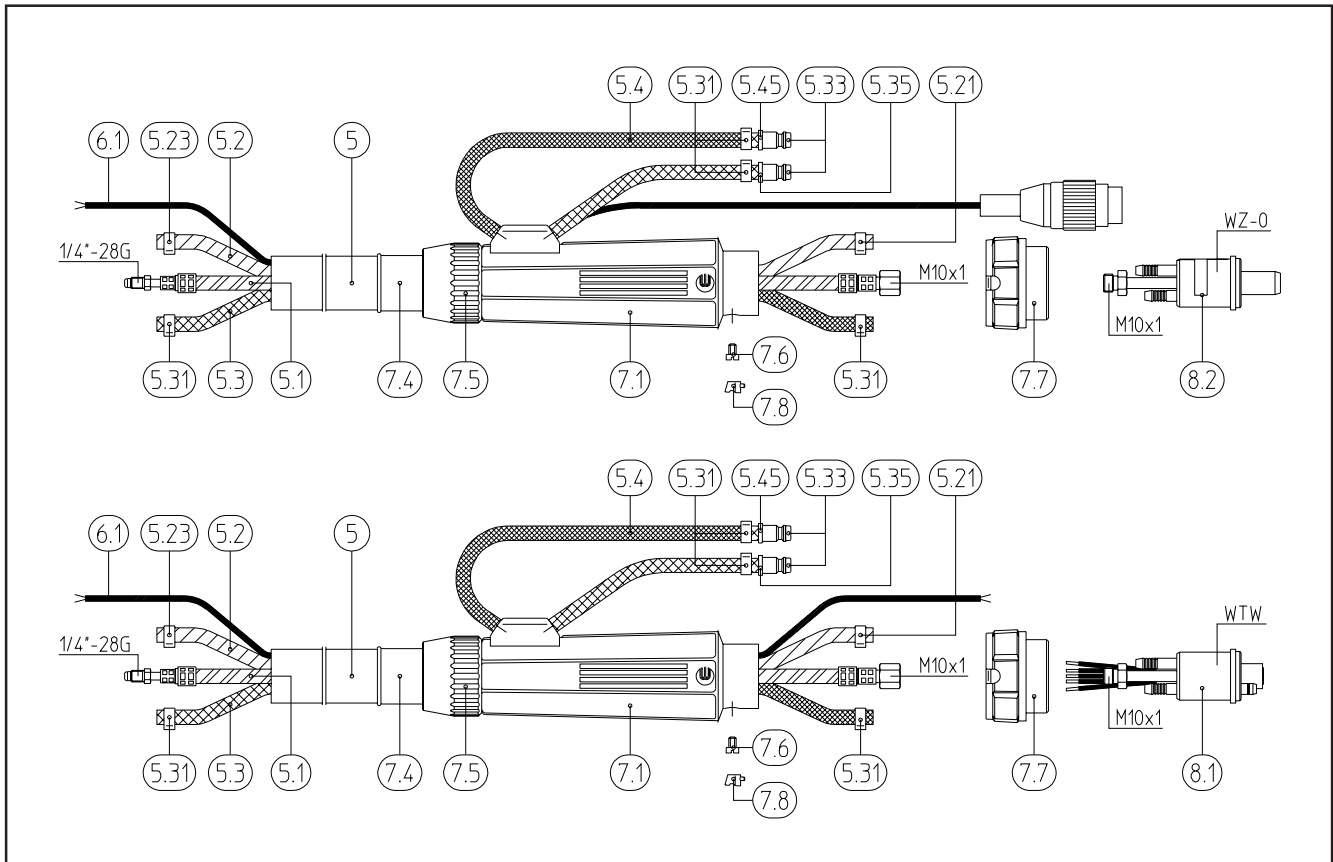

Build group	Pos.	Description	Specifications	Part no.
Handle and switch		Handle with single action switch and potentiometer (Resistore must be specified)		705.0014
		Consisting of:		
		Handle		705.0636
		Screw 2.2x13	20 pcs.	079.0006
		Bung		705.0019
		Incher housing, single switch		705.0339
		Incher housing, double switch		705.0526
		Micro switch		185.0011
		Knurled knob for potentiometer		705.0020
		Screw M3x6 for potentiometer	20 pcs.	005.0057
		Potentiometer with nut (Resistore must be specified)		187.xxxx
	2.3	MG-handle with single action switch		701.0133
		MG-handle with double action switch		701.0698
		Consisting of:		
	Handle with switch		701.0134	
	Micro switch		185.0011	
	Pressure spring	20 pcs.	701.0987	
	Cylinder pin 2m6x8	20 pcs.	063.0001	
	Screw 2.2x13	20 pcs.	079.0005	
	O-ring 17x2.5	20 pcs.	165.0040	
2.31	Insert bush		705.0013	
2.32	O-ring 17x2.5	20 pcs.	165.0040	
3.1	Binzel switch		701.0140	
	Countersunk screw M4x6	20 pcs.	009.0201	

Build group	Pos.	Description	Specifications	Part no.
<b>Handle and switch</b>	3.2	Rubber switch		185.0013
	3.3	Double switch		185.0015
	4.1	Cable support		701.0139
<b>Cable assembly</b>	5	Outer cover rubber Ø 20x1.5	per meter	105.0005
	5.1	Power cable liquid-cooled for 4.00 m (Single connection/BSB)		116.0031
		Power cable liquid-cooled for 8.00 m (Single connection/BSB)		116.0032
		Power cable liquid-cooled for 4.00 m (WTW/WZ-0)		116.0024
		Power cable liquid-cooled for 8.00 m (WTW/WZ-0)		116.0025
	5.2	Hose Ø 3x1.5	per meter	102.0124
	5.21	Hose clamp Ø 8.7 mm	20 pcs.	171.0002
	5.22	Nut G 1/4"		500.0082
		Nipple for G 1/4"		720.0017
	5.3	Hose 22 black Ø 5.5x1.5	per meter	109.0032
	5.31	Hose clamp Ø 9.5 mm	20 pcs.	173.0002
	5.32	Nut G 3/8"		500.0081
		Nipple for G 3/8"		500.0083
	5.33	Quick connector	20 pcs.	501.0114
	5.35	Code colour ring blue	20 pcs.	501.2167
	5.4	Red water hose, cpl., with quick connector, 0.5 m		103.0100
	5.45	Code colour ring red	20 pcs.	501.2166
	6.1	Control cable 2-pole protected	per meter	100.0017
		Control cable 2-pole unprotected	per meter	100.0019
		Control cable 3-pole protected	per meter	100.0022
		Control cable 3-pole unprotected	per meter	100.0023
		Control cable 5-pole protected	per meter	100.0028
	w/o fig.	Electric-Insulation hose (for unprotected control cable 100.0019 and 100.0023)	per meter	110.0004
	6.21	Tuchel plug 3-pole		175.0009
	6.22	Tuchel plug 5-pole		175.0011
	6.23	Amphenol plug 4-pole		175.0006
	6.24	Harting plug 6-pole		175.0013
		Other plug types are available on request.		
	7.1	Connecting case complete with hose passage		500.0342
	7.4	Cable support		400.0101
	7.5	Nut		400.0137
	7.6	Screw M4x6	20 pcs.	000.0552
	7.7	Adaptor nut		500.0213
8.1	Central adaptor block WTW 5-pole		501.0062	
8.2	Central adaptor block WZ-0		501.0075	
	BSB Plug with side entry		500.0177	
	Consisting of:			
8.31	Power fitting		500.0060	
8.32	Rubber insulator		500.0141	
8.33	Hose fitting		500.0255	

---

Welding & cutting brought to the point.



Alexander Binzel Schweißtechnik GmbH & Co. KG  
P.O. Box 10 01 53 · D-35331 Gießen  
Tel.: ++49 (0) 64 08 / 59-0  
Fax: ++49 (0) 64 08 / 59-191  
Internet: [www.binzel-abicor.com](http://www.binzel-abicor.com)